



Heater **Whisper K-200**

Economical Compact Heater

MCC Whisper K-200 compact heating unit is a part of the Whisper 200 family, its compact size means that it can be mounted anywhere. The whisper K-200 consists of a heat exchanger and four brushless fans (12VDC or 24VDC) with

long life bearings for quiet operation. All components are mounted in a rugged anodized aluminum case with integrated mounting bracket for simple installation.

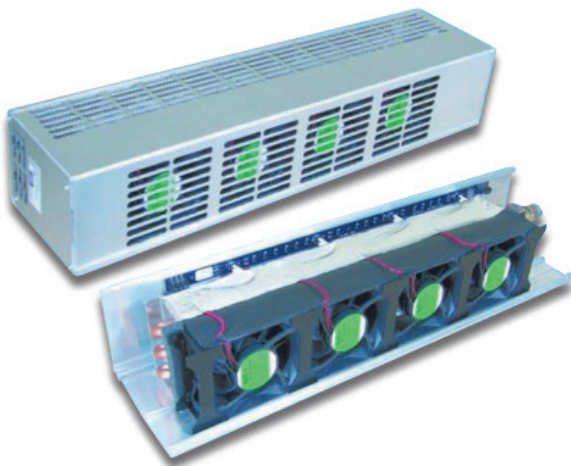

Features

- Heater system for interior heating in buses with water/glycol based heating systems
- Piping can be mounted either left or right side
- Smooth air distribution
- Compact and light weight design
- Long life brushless fans

Heaters **Whisper K-200**

MCC Heaters

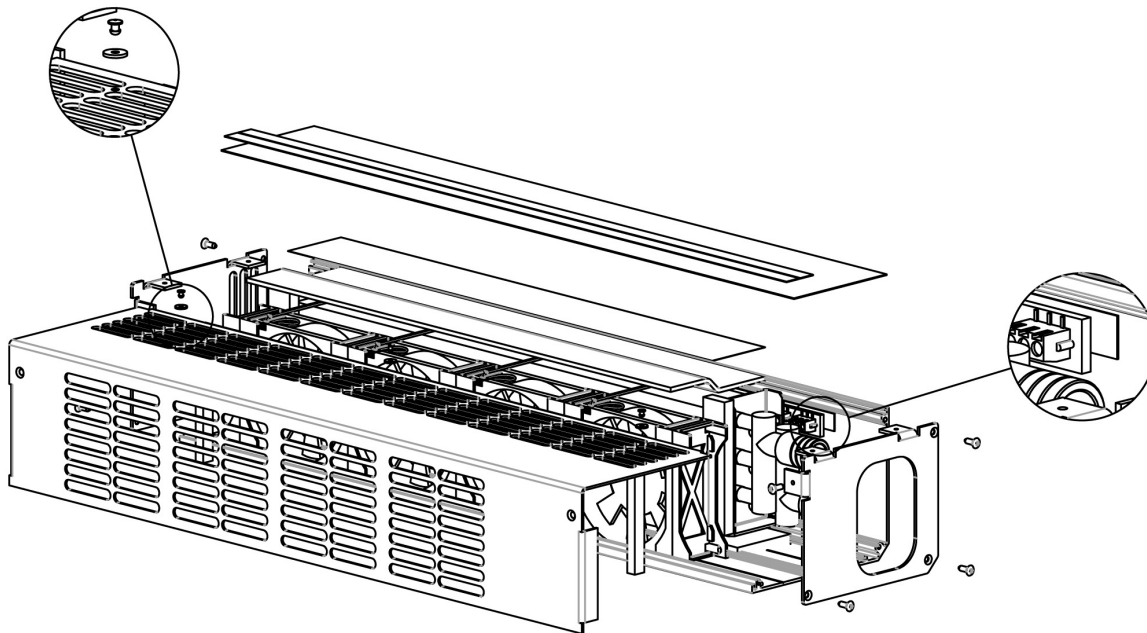

Technical Data

Operating voltage/Maximum operating voltage	24/28 VDC	
Power consumption	0.8 A/19 W	
K200 meets the requirements according to:	Low Voltage Directive 73/23/EEC EMC Directive 89/336/EEC CE Marking Directive 93/68/EEC	
Standard connection	Direct to circuit board	Black = Ground Red = High speed Blue = Low speed
Heat ^[1]	8190 Btu/hr (2.4 kW) Q_{60}	13649 Btu/hr (4.0 kW) Q_{100}
Air flow	103 CFM (175 m ³ /h)	
Coolant connections	Connections to K200 are with \varnothing 0.9" (22 mm) hoses.	

{1} The Q_x value stands for the temperature difference between the water inlet temp and the air temp in the room where the heat exchanger is. For instance water inlet temp +80°C and air temp +20°C is known as Q_{60} .

