



## Compressor Valeo **TM-08**

# Compact and adaptable for Off Road equipment

The TM series compressors were designed to cover a wide range of applications, ideal for any customer requiring adaptation flexibility. The TM compressors incorporate the latest design improvements to better meet the needs of today's Heavy Duty systems.

The TM family boasts extends to:

- The drive end, through a wide range of interchangeable pulley profiles (A, B and PKP), pitch diameters and bi-directional clutch plates
- The refrigerant connections end, through a range of back caps or a wide range of fittings that are pad-mounted to the back cap



### Features

- High efficiency and performance
- Lightweight and compact compressor
- Many adaptations with a large choice of clutches and fittings
- High reliability
- Low vibrations and noise
- Suitable for heavy duty applications

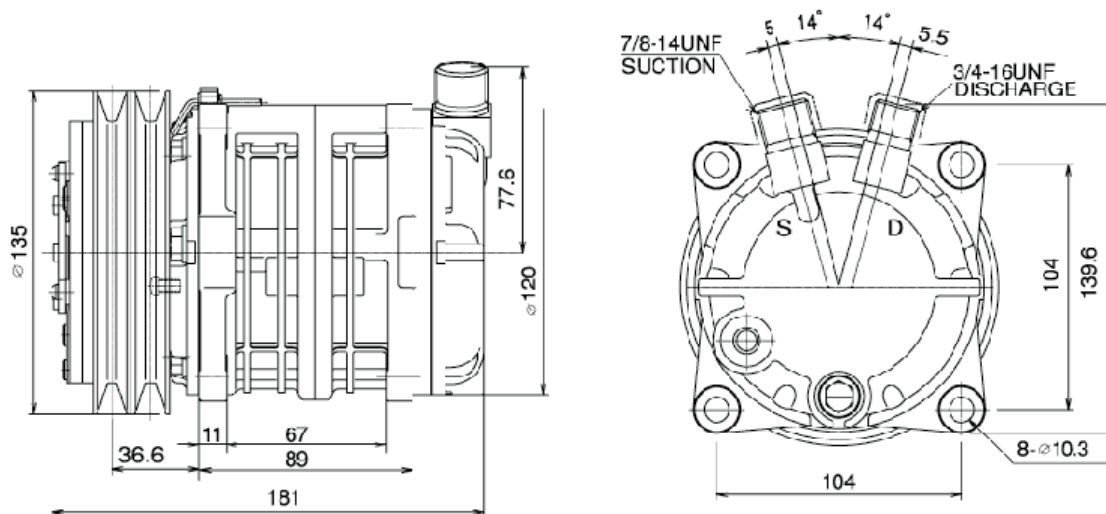

## Technical Data

Rotation	CW / CCW
Max speed	700 – 6000 rpm
Clutch coil	12 or 24 VDC
Displacement	5 in <sup>3</sup> (82 cm <sup>3</sup> )
Number of pistons	6
Refrigerant	R134a
Pulleys <sup>[1]</sup>	125-2AG 135-1AG 135-2AG 137-1bg 119 (4PK / 6PK / 8PK)
Mounting	EAR
Unloading steps	N/A
Oil charge	ZXL 100PG PAG OIL 5.3 oz (150 cm <sup>3</sup> )
Weight (without clutch)	9 lbs (4.1 kg)

[1] Outside diameters



**Mobile Climate Control**